

COME FOR THE CHILI-
FOR THE CON!
STAY FOR THE CON!

San Antonio in '97



© BRAD
AND
CINDY
FOSTER 1993

**The Second Occasional
LoneStarCon**
Science Fiction Convention and Chili Cook-off
P.O. Box 291015 San Antonio, TX 78229-1015



What is a Worldcon Bid? Future Worldcon sites are decided three years in advance by current Worldcon members. So the 1997 convention site will be voted on by the membership of the 1994 con, Conadian in Winnipeg. Groups wanting to host a Worldcon compete by bidding, convincing potential voters that they have what it takes. The major visible portion of this procedure is the Bid Party, thrown at other conventions to promote their con and city.

The LoneStarCon bid committee has picked San Antonio to host the first Worldcon ever held in Texas. The city has major benefits:

The Convention Center: Located downtown, the Convention Center boasts two halls (each over 120,000 square feet), large ballrooms, the Theater, scores of smaller meeting rooms, and the Arena, home for the San Antonio Spurs.

The Hotels: Two Marriott hotels, the Riverwalk and Rivercenter, are literally across the street from each other and the Convention Center. The Rivercenter is linked to the Rivercenter Mall, with dozens of shops and restaurants. The Mall, hotels, and Convention Center are linked by a branch of the world-famous Paseo del Rio, the River Walk. You can easily walk from one to another without dealing with traffic and enjoy the cool, shaded comfort of the San Antonio River. There are a dozen other hotels within three or four *small* blocks in all prices, from the stately Menger to La Quinta.

Food: Every conceivable type of cuisine and setting is within easy walking distance. From McDonald's to the Tower of the Americas, every price range is available for every palate.

Parking: More than you really want to think about, from a couple of dollars a day on up.

Getting to San Antonio: Flying in, the International Airport is on every major airline's route. It's only 15 to 20 minutes from downtown by taxi, courtesy van, or Via, the metro transportation system. For drivers, San Antonio is located at the crossroads of IH-35 and IH-10.

Other Attractions: San Antonio offers plenty for vacationers: Sea World of Texas, the Texas Fiesta theme park with the world's tallest wooden roller coaster, museums, and a world-class zoo. The Gulf of Mexico and NASA's Johnson Space Center are only a couple of hours away by car.

Pre-Supporting Memberships: Your donation helps finance parties and other activities to spread the word about San Antonio. This kind of membership costs just \$8 US. In return, you receive a newsletter detailing our progress (and some of the things being done to promote the bid) and a really cool button. Pre-Opposing Memberships are \$10 US and come with the same benefits. There are additional classes of memberships if you're interested.

You can also become a supporting or attending member of Conadian, the 1994 Worldcon, and participate in site selection by voting for San Antonio. Attending memberships are \$85 US 'til September 6, 1993; supporting memberships are \$25 US. Write to them at: Conadian, P.O. Box 2430, Winnipeg, Manitoba, Canada R3C 4A7. You'll need to put 2 stamps on the envelope.

The choice is yours. We thank you for your support!



**"Everything's bigger in Texas..."
A Worldcon won't be an
exception to the rule!**

San Antonio in 1997

Currently accepting Pre-Supporting Memberships for just 8 bucks* (Pre-Opposers can add another 2 dollars* to that). We also have nifty buttons and t-shirts. Oh, yeah, and chili. We got **LOTS** of chili. Try some out at one of our parties.

P.O. Box 291015
San Antonio TX 78229-1015
(Inquiries please send an SASE)

*That's US currency, not Republic of Texas tender.

Don't forget to vote in the Site Selection at Conadian, the 1994 Worldcon in Winnipeg!



The Second Occasional
LoneStarCon
Science Fiction Convention
and Chili Cook-Off

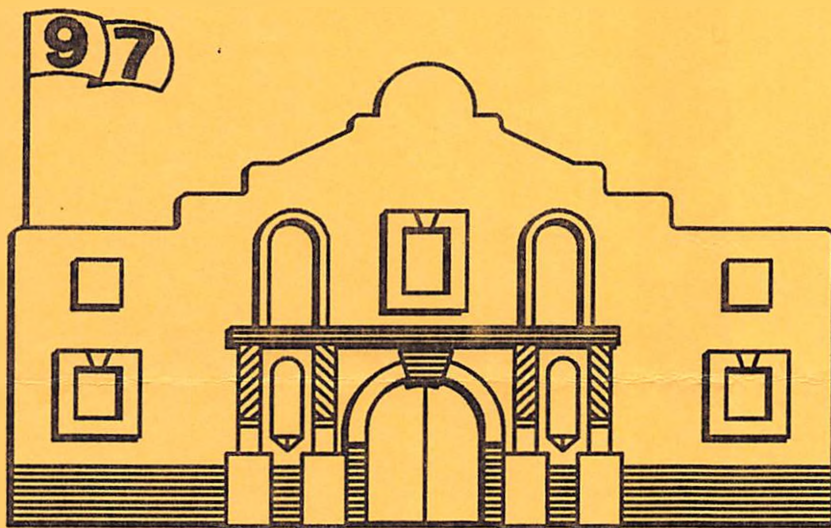

*A Bid for the
1997 WorldCon
To Be Held in
San Antonio,
Texas*

San Antonio -- home of the Alamo and the Riverwalk. Site of many other attractions, including Sea World and the all-new Texas Fiesta with the world's largest wooden rollercoaster. Brought to you in the same, down-home Texas style that was so much fun in Austin back in 1985.

We are currently accepting Pre-Supporting Memberships of \$8.00 (U.S.) and Pre-Opposing Memberships of \$10.00 (U.S.). We also have T-Shirts featuring our Alamo logo for \$10.00 and Buttons in different styles for \$1.00. For all of these items and information on our Special Pre-Supporting Memberships, send an SASE to the address listed below. Or come to one of our Bid Parties and sample some Texas-style Chili.

LoneStarCon 2

**P.O. Box 291015
San Antonio TX
78229-1015**

JOIN THE PARTY! Vote San Antonio in '97

Al and Mo, Tank and Bev are at the head of the parade, and if you look real close you may see a bunch of other people you know ready to vote for San Antonio in '97. How 'bout you? Remember, you're the one who decides where the '97 Worldcon will be. And it's easy to vote, whether your travel plans call for a trip north or not.

All you need to vote is an Attending or Supporting membership in Conadian, the 1994 Worldcon. Attending memberships are \$125US, while Supporting memberships are just \$25US. Another \$25US will get you an automatic Supporting membership in the winning Worldcon when you vote. For just \$60US when you vote, you automatically get an Attending membership in the 1997 Worldcon. You can write Conadian at: PO Box 7111, Fargo, ND 58109.

Thanks for all your support over the last few years.

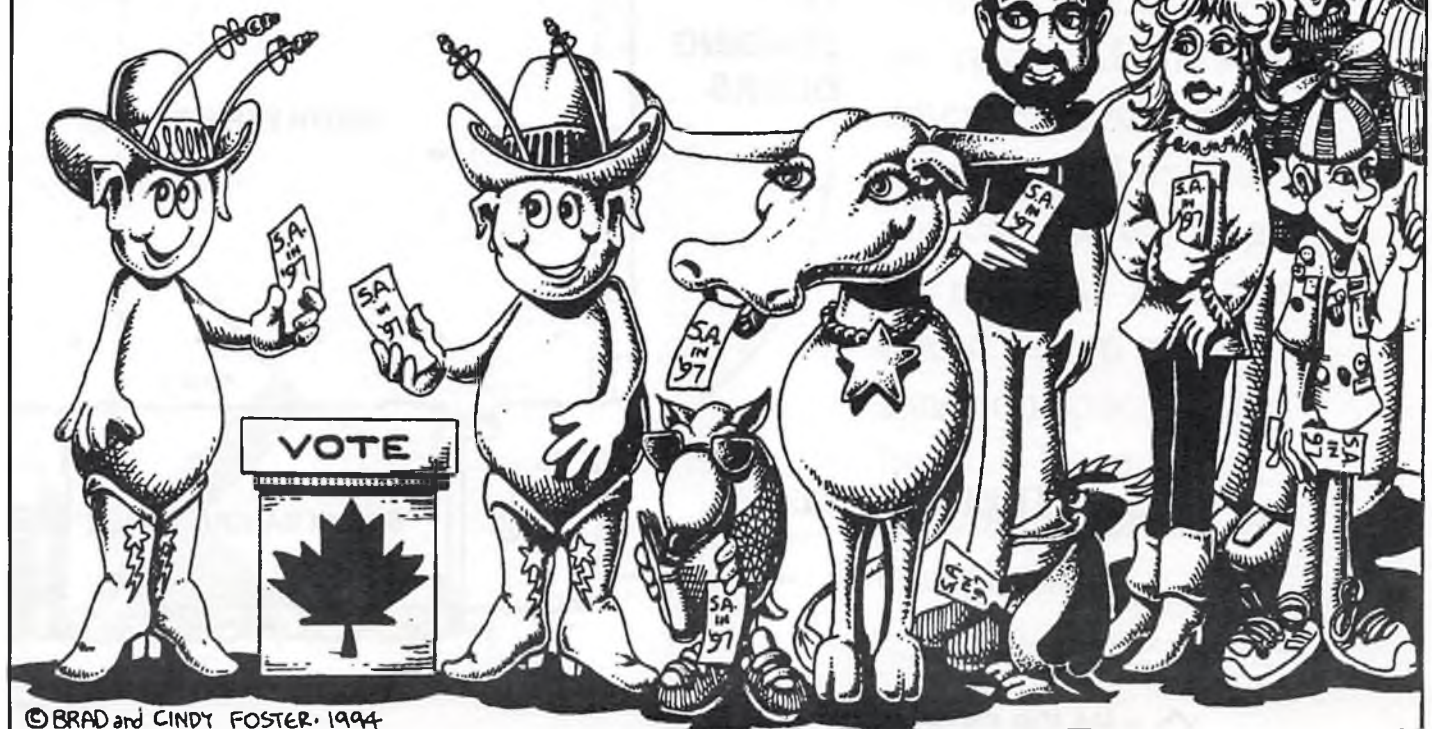

The San Antonio

MARKET ST. (ONE WAY) ↻

CONVENTION WAY

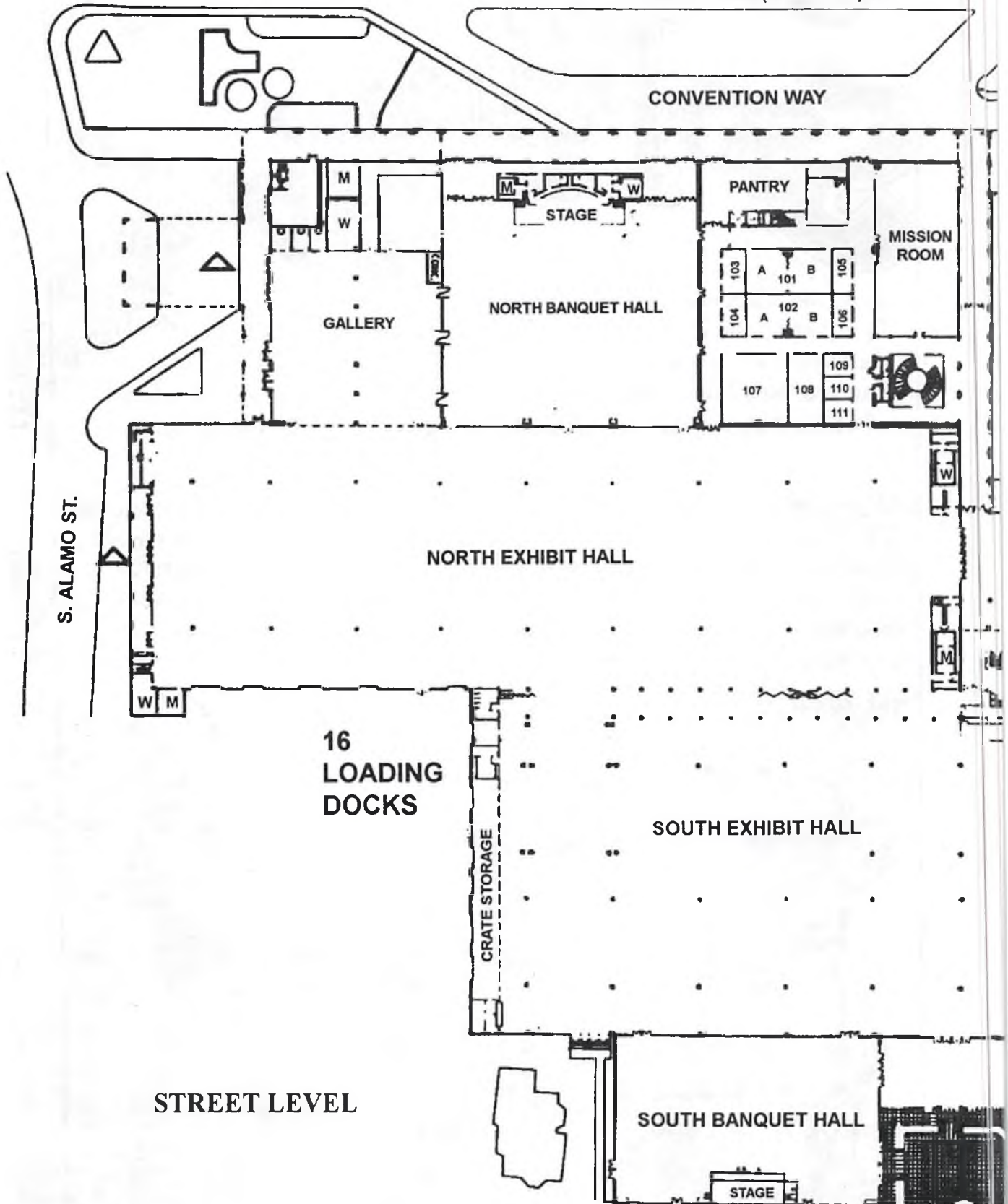

S. ALAMO ST.

STREET LEVEL

△ = MAJOR ENTRANCE

Convention Center

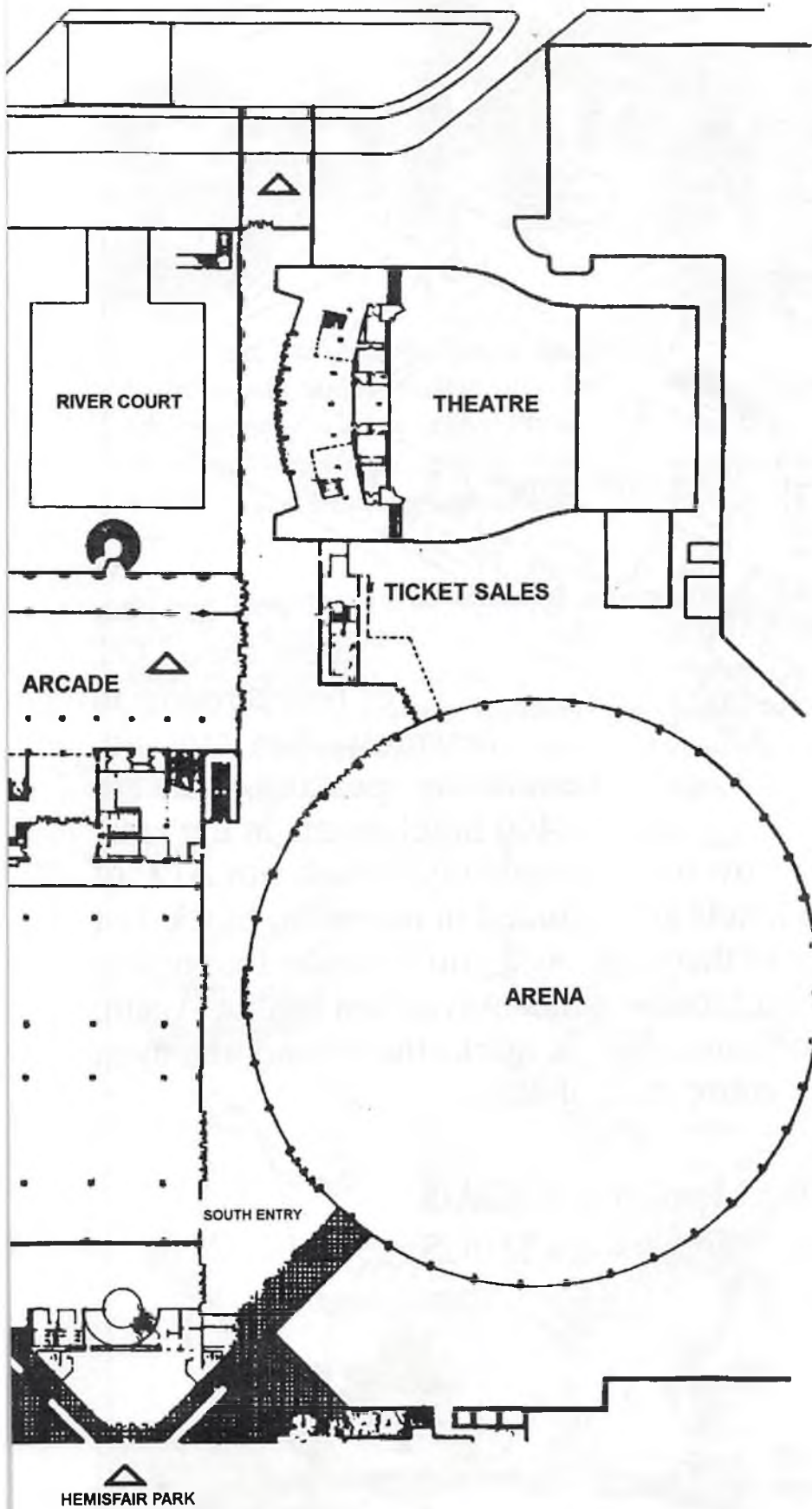

Jeez, would ya look at the size of this thing... And that's just the street level! There's two other levels, one up and one down by the Riverwalk around the River Court, with another 27 rooms and a rehearsal hall. The Dealers' Room (Hucksters in some dialects), Art Show and possibly a ConCourse will be in the North and South Exhibit Halls with 225,000 square feet between them. Now, we're not REAL sure where everything else is gonna end up, but you can see we've got the room(s). And this doesn't even count function space at the hotels!! Even better, it's completely ADA-compliant!

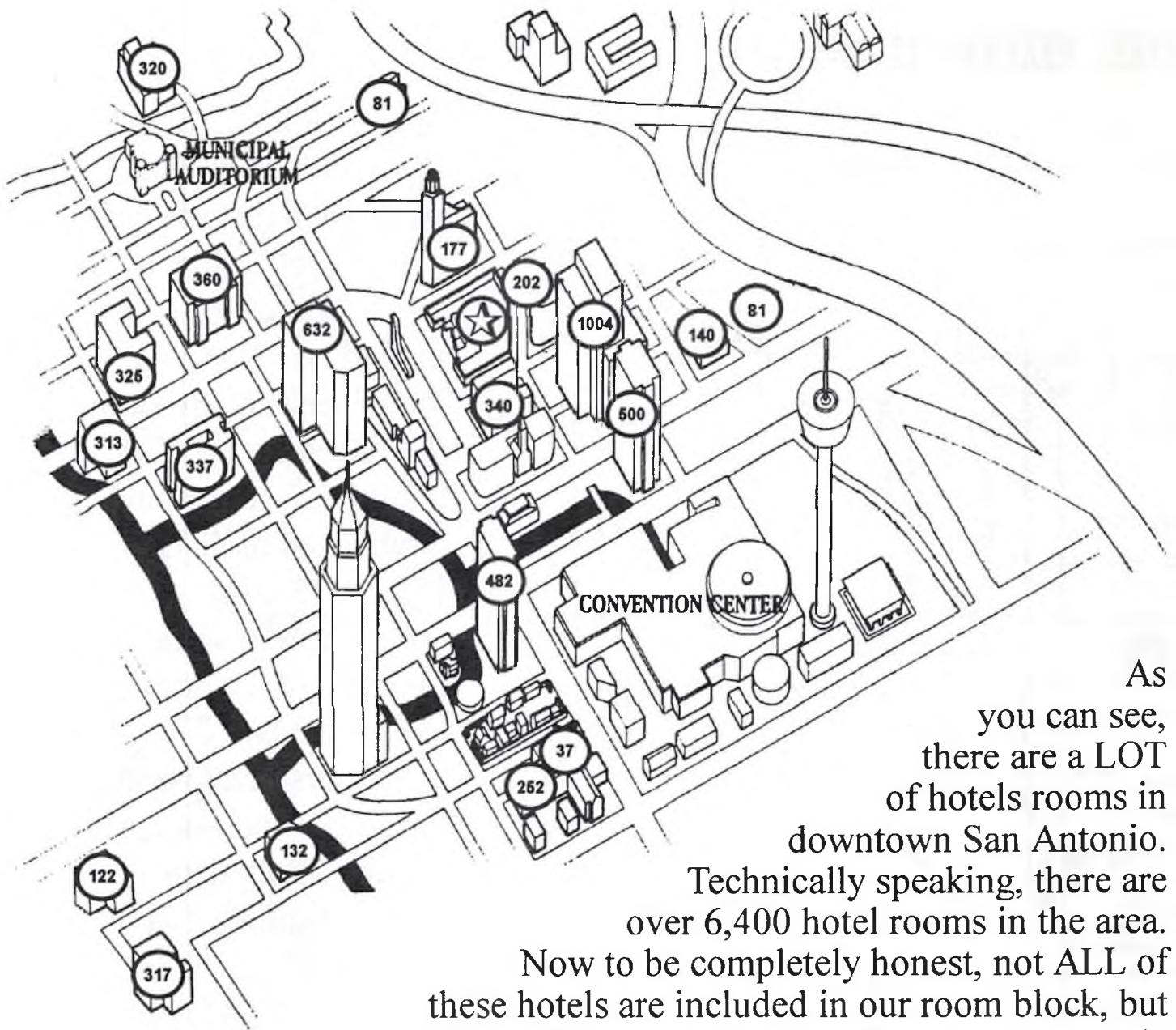

As you can see, there are a LOT of hotels rooms in downtown San Antonio. Technically speaking, there are over 6,400 hotel rooms in the area. Now to be completely honest, not ALL of these hotels are included in our room block, but an awful lot of them are. And you'll notice that nearly 3,500 rooms are within three short blocks of the convention center. Again, to be honest, one location has no rooms: the ☆ marks the Alamo, the most popular tourist destination in the entire state of Texas.

Pre-Supporting Memberships \$8US
 Pre-Opposing Memberships \$10US

The Second Occasional
LoneStarCon
 Science Fiction Convention and Chili Cook-off
 P.O. Box 291015 San Antonio, TX 78229-1015

